

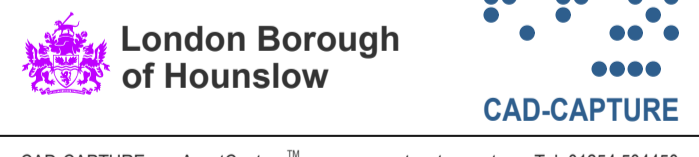

- Sports Pitches
- Soft Informal and Social Area
- Hard Informal and Social Area
- Buildings
- Associated Non-Net Area
- Access



01	Update by Cad-Capture	CC	ARB	31/10/2018
00	Updated by Cad-Capture	CC	ARB	15/10/2014
Rev	Description	Drm	Chk	Date



CAD-CAPTURE AssetCapture™ www.assetcapture.net Tel: 01254 504450

Property: Alexandra Primary School  
 Title: Site Plan

<b>Area Information</b>		Job:	S6615
Total Site Area:	14285.1	Scale:	1:350@A1 1:700@A3
Gross External Area:	4344.8	Date:	15/10/2014
Gross Internal Area:	4119.1	Survey:	05/09/2014
Total Room Area:	3898.0	Drawn:	CAD-CAPTURE
Net Internal Area:	2663.2	Checked:	ARB
Filename:	2014 - Alexandra Primary School.dwg		
Drawing No:	313/2014		

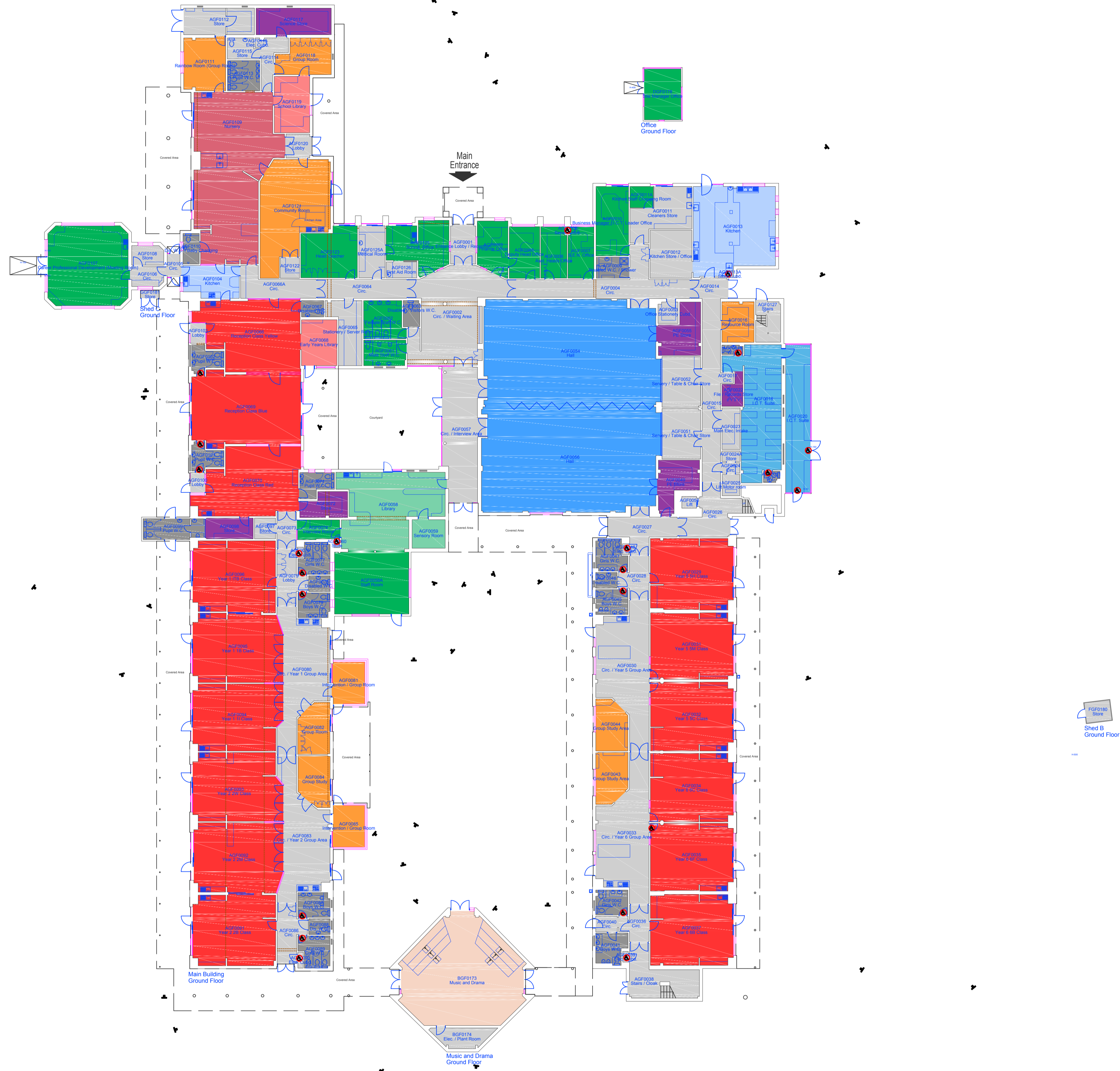
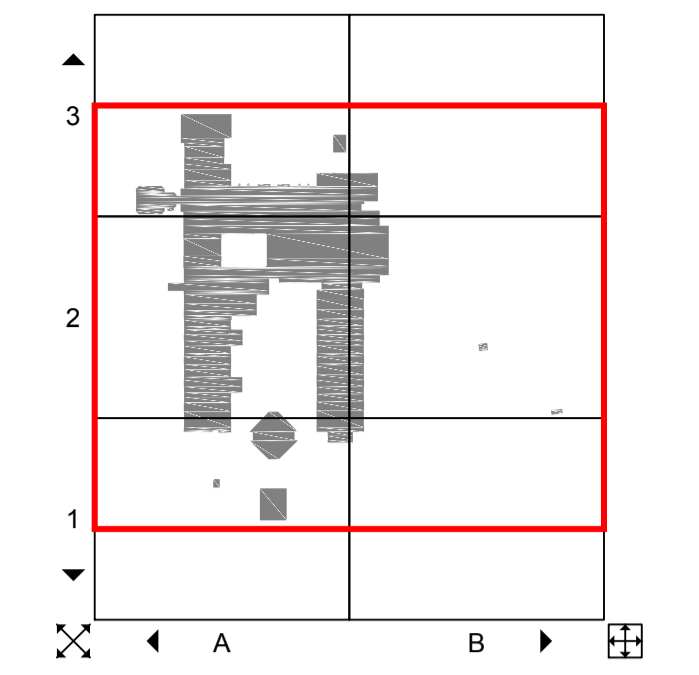

- |  |                  |  |                        |
|--|------------------|--|------------------------|
|  | General Teaching |  | Library                |
|  | Science          |  | Resource Areas         |
|  | I.T.             |  | Common Room            |
|  | Art              |  | Nursery                |
|  | Technology       |  | Other                  |
|  | Music            |  | Other                  |
|  | Drama            |  | Staff and Admin Spaces |
|  | P.E.             |  | Pupil Changing/Toilets |
|  | S.E.N.           |  | Teaching Storage       |
|  | Private Study    |  | Kitchen/Dining         |
|  | Hall             |  | Ancillary/Circulation  |



01	Updated by Cad-Capture	CC	ARB	31/10/2018
00	Updated by Cad-Capture	CC	ARB	15/10/2014
Rev	Description	Drm	Chk	Date

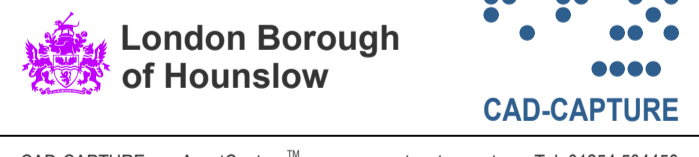

CAD-CAPTURE AssetCapture™ www.assetcapture.net Tel: 01254 504450

Property: Alexandra Primary School  
Title: Ground Floor Plan

<b>Area Information</b>	Job: S6615
Total Site Area: 14285.1	Scale: 1:210@A1 1:420@A3
Gross External Area: 4344.8	Date: 15/10/2014
Gross Internal Area: 4119.1	Survey: 05/09/2014
Total Room Area: 3898.0	Drawn: CAD-CAPTURE
Net Internal Area: 2663.2	Checked: ARB
Filename: 2014 - Alexandra Primary School.dwg	
Drawing No: 313/2014	

Alexandra Primary School  
25051  
2014  
Site Area: 14285.1  
Gross External Area: 4344.8  
Gross Internal Area: 4119.1  
Total Room Area: 3898.0  
Net Internal Area: 2663.2

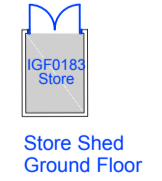
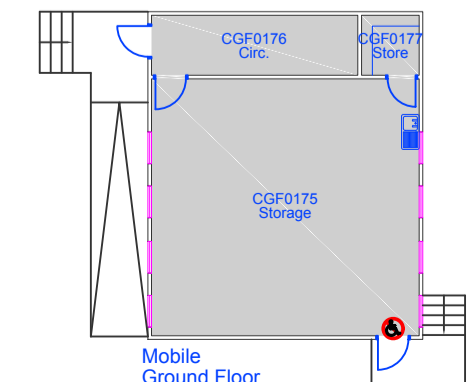

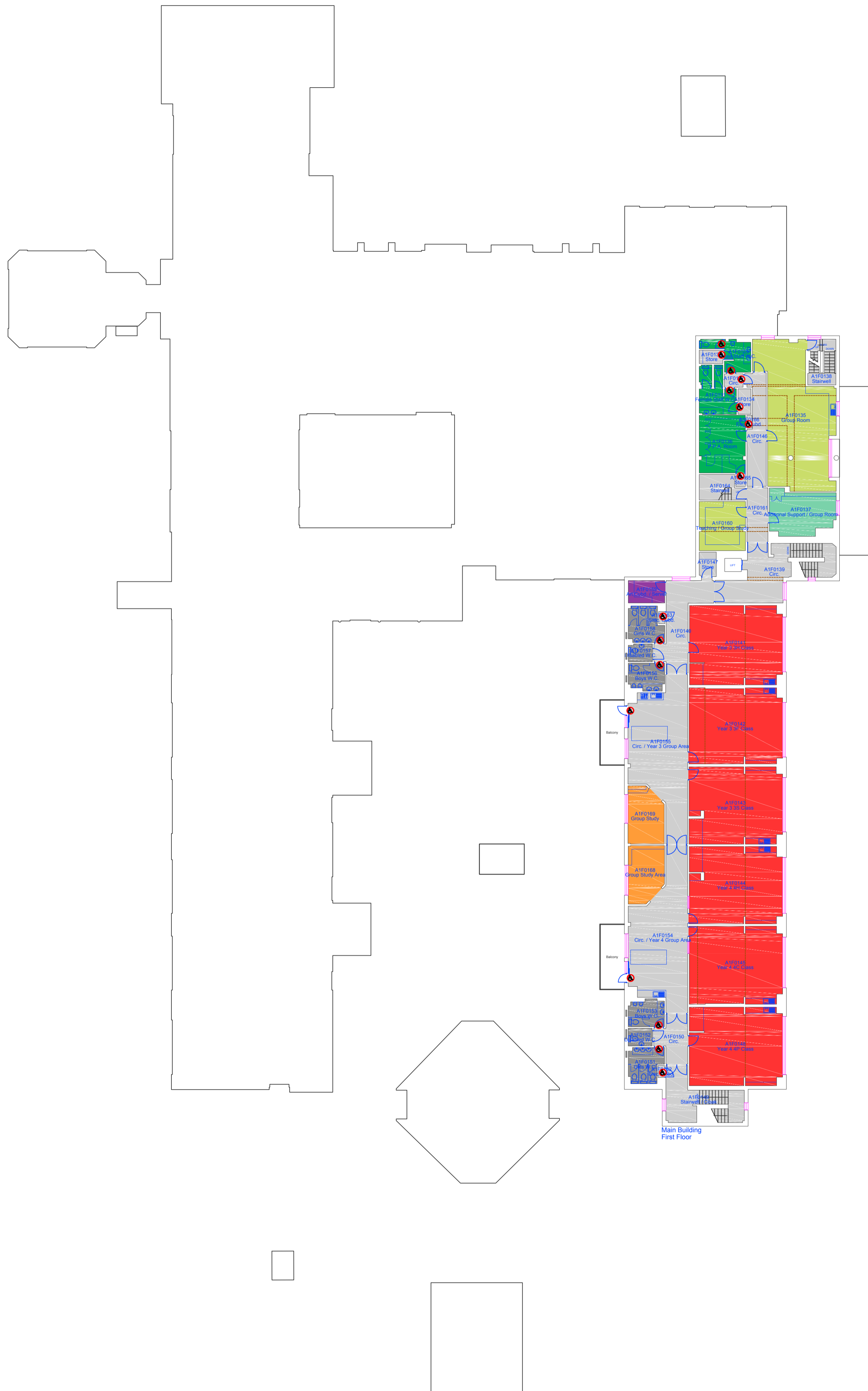
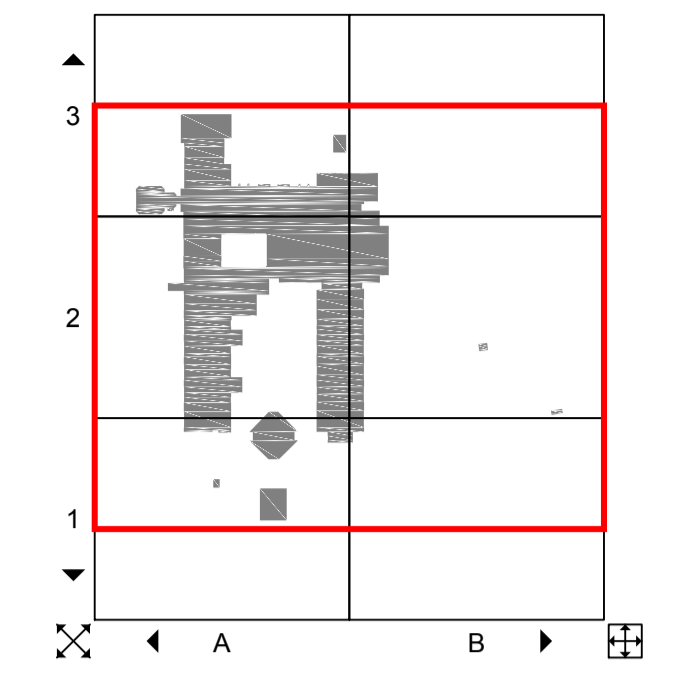

- |  |                  |  |                        |
|--|------------------|--|------------------------|
|  | General Teaching |  | Library                |
|  | Science          |  | Resource Areas         |
|  | I.T.             |  | Common Room            |
|  | Art              |  | Nursery                |
|  | Technology       |  | Other                  |
|  | Music            |  | Other                  |
|  | Drama            |  | Staff and Admin Spaces |
|  | P.E.             |  | Pupil Changing/Toilets |
|  | S.E.N.           |  | Teaching Storage       |
|  | Private Study    |  | Kitchen/Dining         |
|  | Hall             |  | Ancillary/Circulation  |



Rev	Description	Drm	Chk	Date
01	Updated by Cad-Capture	CC	ARB	31/10/2018
00	Updated by Cad-Capture	CC	ARB	15/10/2014

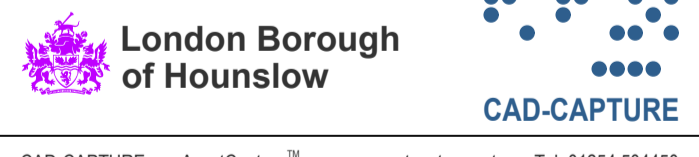

CAD-CAPTURE AssetCapture™ www.assetcapture.net Tel: 01254 504450

Property: Alexandra Primary School  
 Title: First Floor Plan

<b>Area Information</b>	Job: S6615
Total Site Area: 14285.1	Scale: 1:210@A1 1:420@A3
Gross External Area: 4344.8	Date: 15/10/2014
Gross Internal Area: 4119.1	Survey: 05/09/2014
Total Room Area: 3898.0	Drawn: CAD-CAPTURE
Net Internal Area: 2663.2	Checked: ARB
Filename: 2014 - Alexandra Primary School.dwg	
Drawing No: 313/2014	

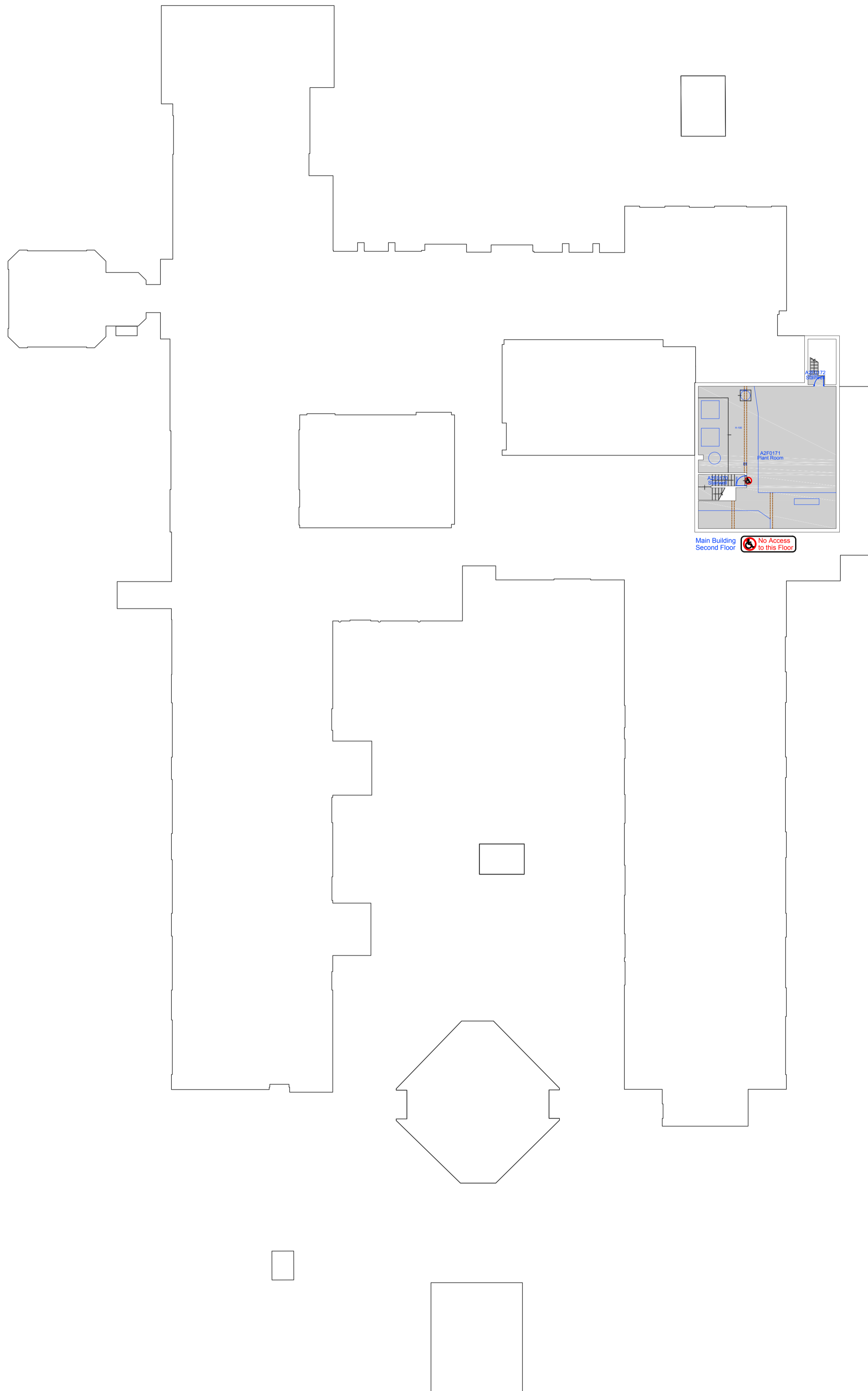
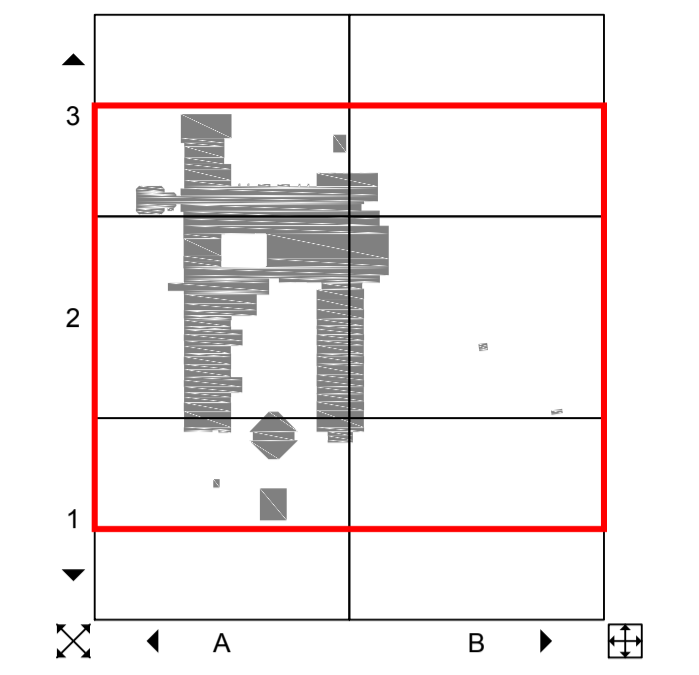

- |  |                  |  |                        |
|--|------------------|--|------------------------|
|  | General Teaching |  | Library                |
|  | Science          |  | Resource Areas         |
|  | I.T.             |  | Common Room            |
|  | Art              |  | Nursery                |
|  | Technology       |  | Other                  |
|  | Music            |  | Other                  |
|  | Drama            |  | Staff and Admin Spaces |
|  | P.E.             |  | Pupil Changing/Toilets |
|  | S.E.N.           |  | Teaching Storage       |
|  | Private Study    |  | Kitchen/Dining         |
|  | Hall             |  | Ancillary/Circulation  |



Rev	Description	Drm	Chk	Date
01	Updated by Cad-Capture	CC	ARB	31/10/2018
00	Updated by Cad-Capture	CC	ARB	15/10/2014

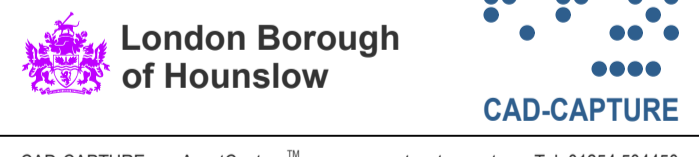

CAD-CAPTURE AssetCapture™ www.assetcapture.net Tel: 01254 504450

Property: Alexandra Primary School  
 Title: Second Floor Plan

<b>Area Information</b>		Job: S6615	
Total Site Area:	14285.1	Scale:	1:210@A1 1:420@A3
Gross External Area:	4344.8	Date:	15/10/2014
Gross Internal Area:	4119.1	Survey:	05/09/2014
Total Room Area:	3898.0	Drawn:	CAD-CAPTURE
Net Internal Area:	2663.2	Checked:	ARB
Filename:	2014 - Alexandra Primary School.dwg		
Drawing No:	313/2014		

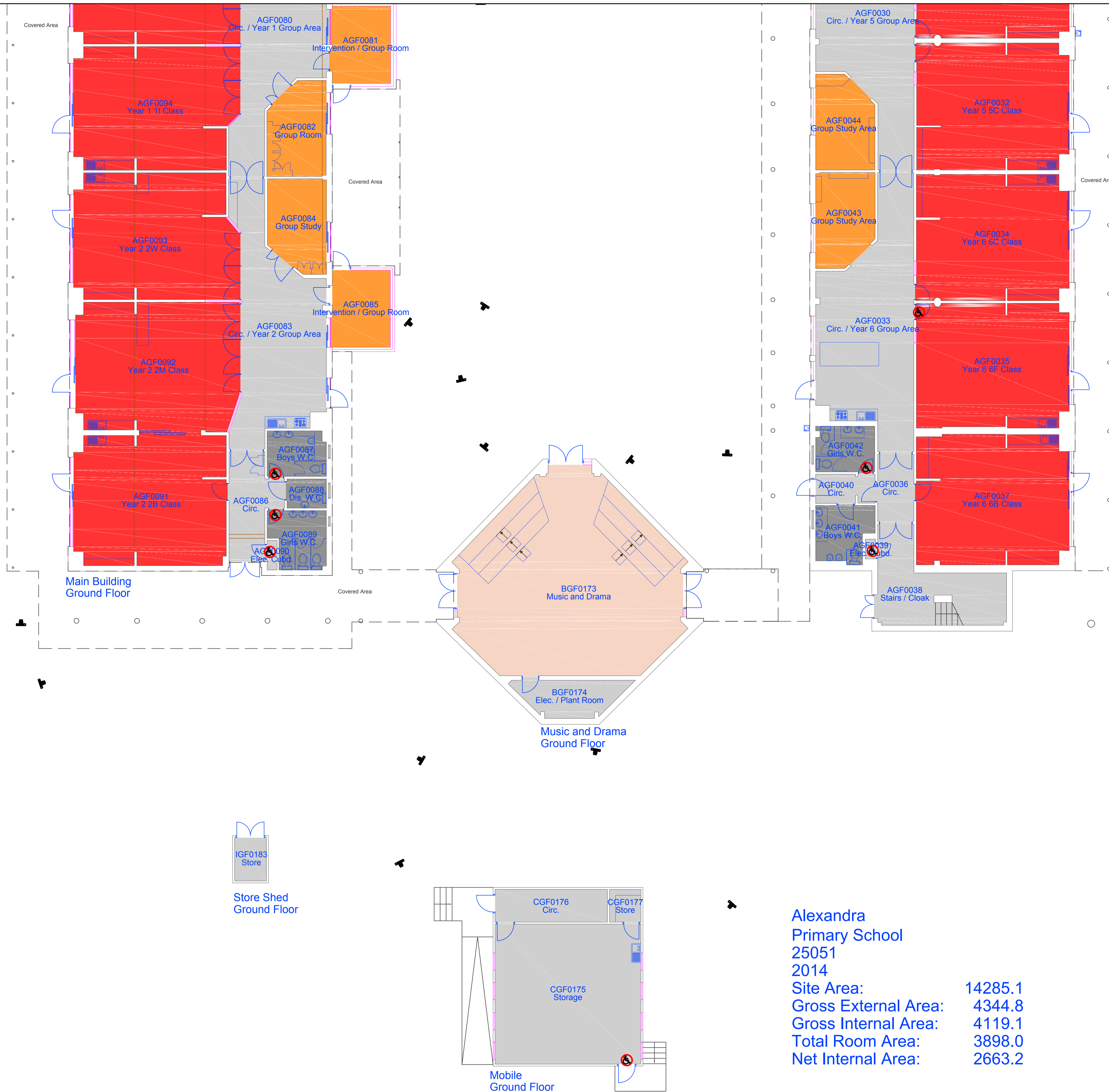

DO NOT SCALE FROM DRAWING. ALL DIMENSIONS MUST BE TAKEN ON SITE.



- |  |                  |  |                        |
|--|------------------|--|------------------------|
|  | General Teaching |  | Library                |
|  | Science          |  | Resource Areas         |
|  | I.T.             |  | Common Room            |
|  | Art              |  | Nursery                |
|  | Technology       |  | Other                  |
|  | Music            |  | Other                  |
|  | Drama            |  | Staff and Admin Spaces |
|  | P.E.             |  | Pupil Changing/Toilets |
|  | S.E.N.           |  | Teaching Storage       |
|  | Private Study    |  | Kitchen/Dining         |
|  | Hall             |  | Ancillary/Circulation  |



Rev	Description	Drm	Chk	Date
01	Updated by Cad-Capture	CC	ARB	31/10/2018
00	Updated by Cad-Capture	CC	ARB	15/10/2014

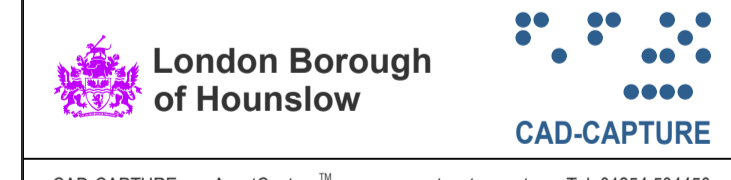

CAD-CAPTURE AssetCapture™ www.assetcapture.net Tel: 01254 504450

Property: Alexandra Primary School  
 Title: Ground Floor Plan Sheet 1

Area Information		Job:	S6615
Total Site Area:	14285.1	Scale:	1:100@A1 1:200@A3
Gross External Area:	4344.8	Date:	15/10/2014
Gross Internal Area:	4119.1	Survey:	05/09/2014
Total Room Area:	3898.0	Drawn:	CAD-CAPTURE
Net Internal Area:	2663.2	Checked:	ARB
Filename:	2014 - Alexandra Primary School.dwg		
Drawing No:	313/2014		

Alexandra  
 Primary School  
 25051  
 2014  
 Site Area: 14285.1  
 Gross External Area: 4344.8  
 Gross Internal Area: 4119.1  
 Total Room Area: 3898.0  
 Net Internal Area: 2663.2

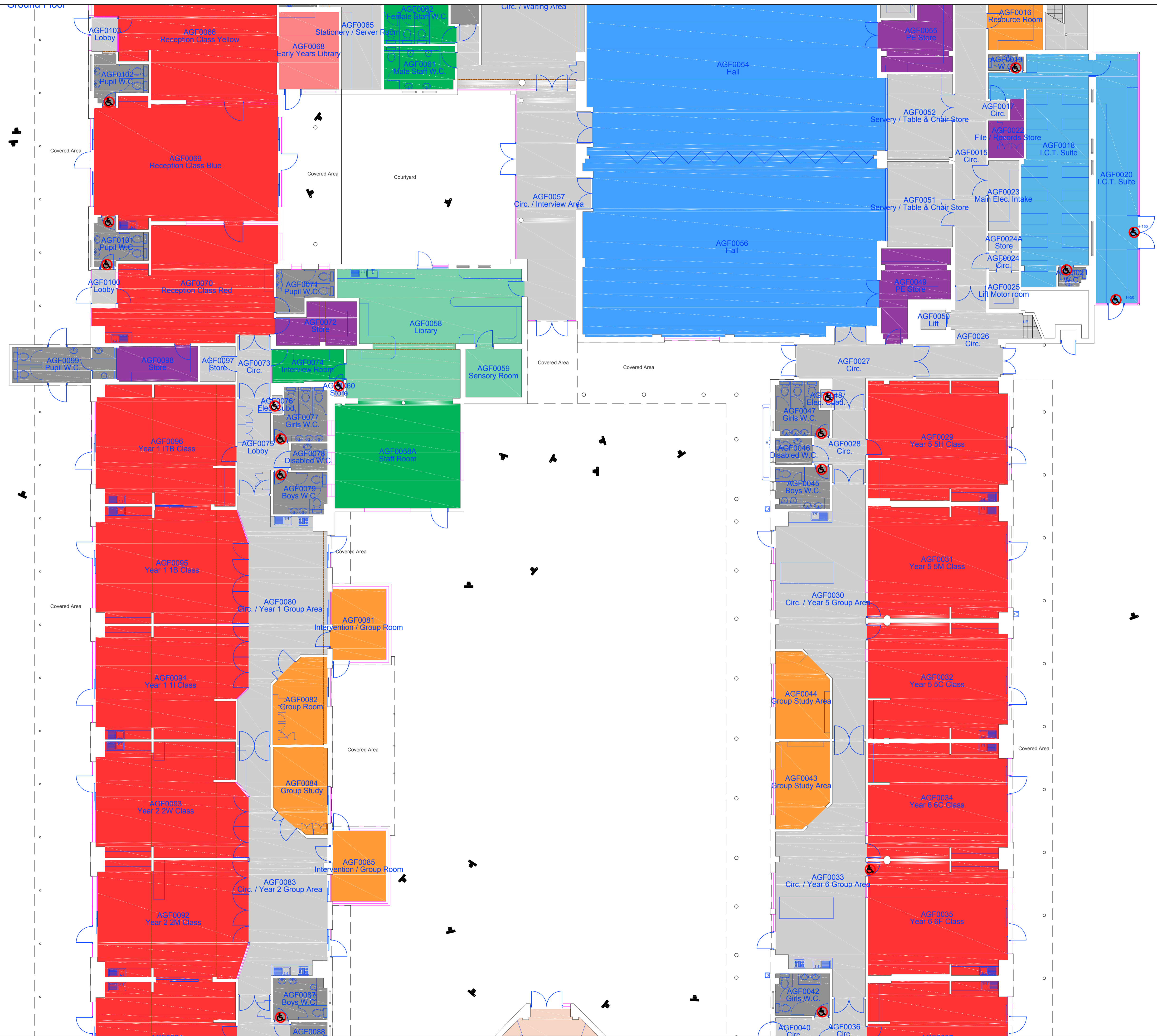
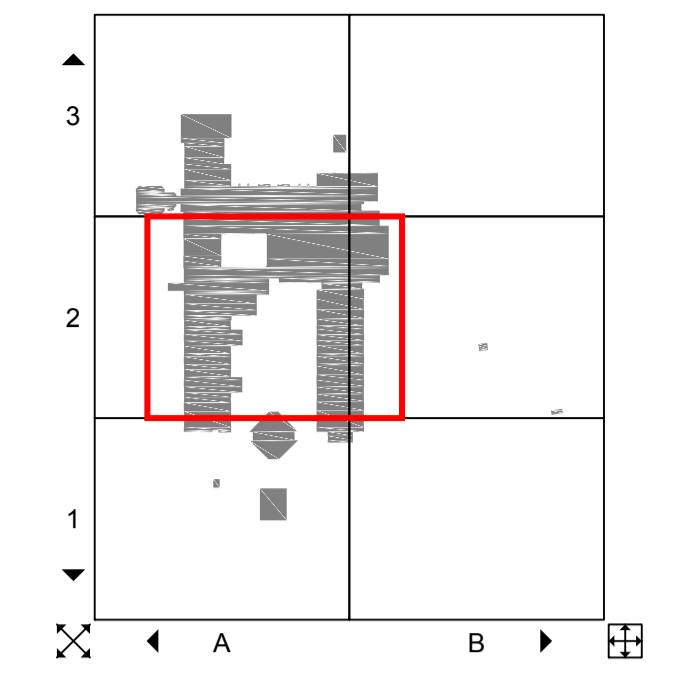

- |  |                  |  |                        |
|--|------------------|--|------------------------|
|  | General Teaching |  | Library                |
|  | Science          |  | Resource Areas         |
|  | I.T.             |  | Common Room            |
|  | Art              |  | Nursery                |
|  | Technology       |  | Other                  |
|  | Music            |  | Other                  |
|  | Drama            |  | Staff and Admin Spaces |
|  | P.E.             |  | Pupil Changing/Toilets |
|  | S.E.N.           |  | Teaching Storage       |
|  | Private Study    |  | Kitchen/Dining         |
|  | Hall             |  | Ancillary/Circulation  |



Rev	Description	Drm	Chk	Date
01	Updated by Cad-Capture	CC	ARB	31/10/2018
00	Updated by Cad-Capture	CC	ARB	15/10/2014

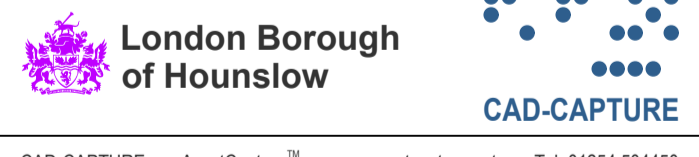

Property: Alexandra Primary School  
 Title: Ground Floor Plan Sheet 2

<b>Area Information</b>	Job: S6615
Total Site Area: 14285.1	Scale: 1:100@A1 1:200@A3
Gross External Area: 4344.8	Date: 15/10/2014
Gross Internal Area: 4119.1	Survey: 05/09/2014
Total Room Area: 3898.0	Drawn: CAD-CAPTURE
Net Internal Area: 2663.2	Checked: ARB
Filename: 2014 - Alexandra Primary School.dwg	
Drawing No: 313/2014	

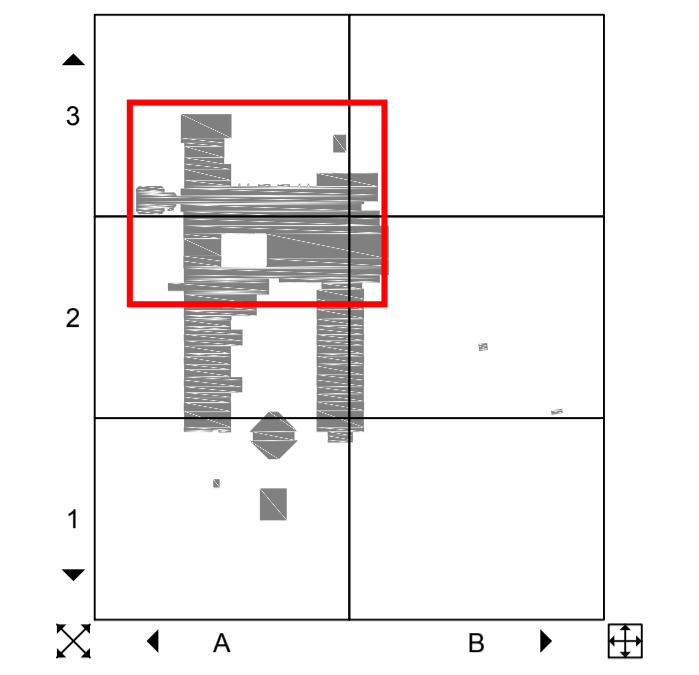

- General Teaching
- Science
- I.T.
- Art
- Technology
- Music
- Drama
- P.E.
- S.E.N.
- Private Study
- Hall
- Library
- Resource Areas
- Common Room
- Nursery
- Other
- Other
- Staff and Admin Spaces
- Pupil Changing/Toilets
- Teaching Storage
- Kitchen/Dining
- Ancillary/Circulation



01	Updated by Cad-Capture	CC	ARB	31/10/2018
00	Updated by Cad-Capture	CC	ARB	15/10/2014
Rev	Description	Drm	Chk	Date



Property: Alexandra Primary School  
 Title: Ground Floor Plan Sheet 3

<b>Area Information</b>	Job: S6615
Total Site Area: 14285.1	Scale: 1:100@A1 1:200@A3
Gross External Area: 4344.8	Date: 15/10/2014
Gross Internal Area: 4119.1	Survey: 05/09/2014
Total Room Area: 3898.0	Drawn: CAD-CAPTURE
Net Internal Area: 2663.2	Checked: ARB
Filename: 2014 - Alexandra Primary School.dwg	
Drawing No: 313/2014	

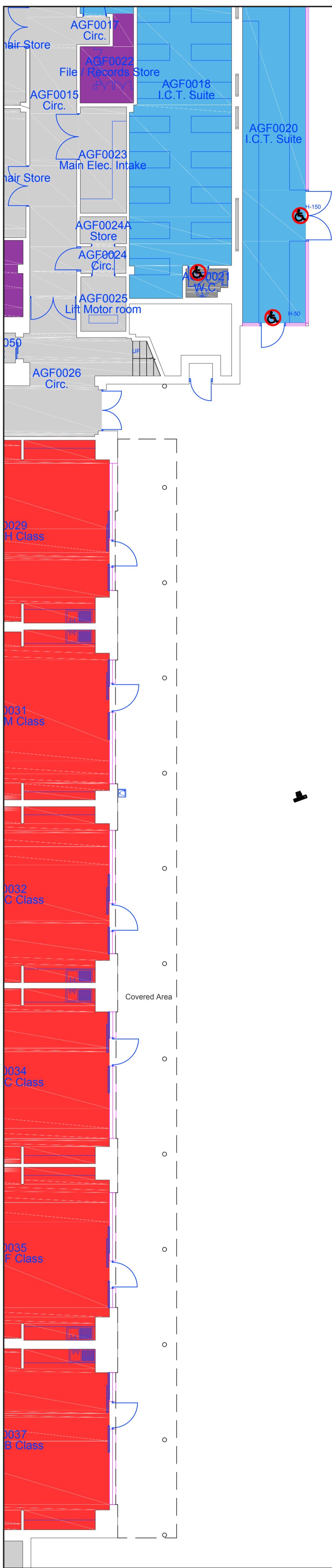
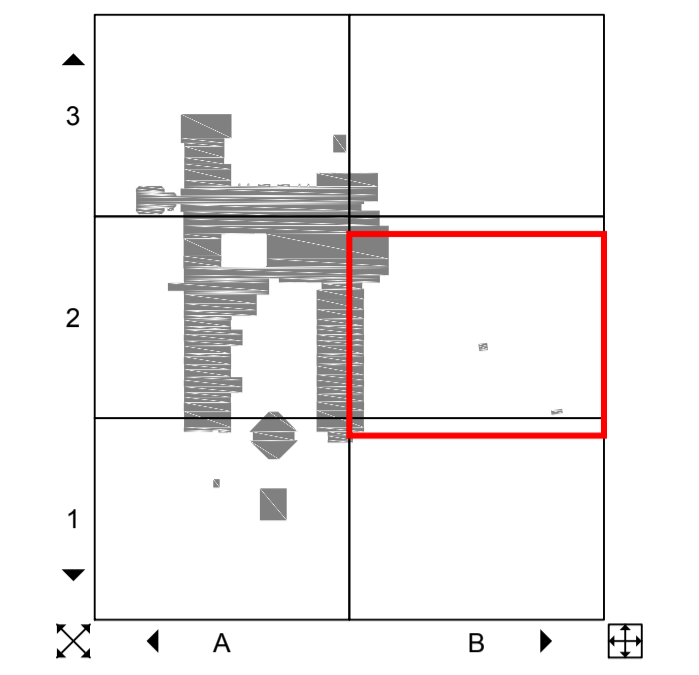

H-500

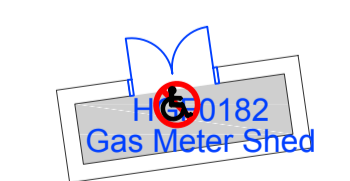

Gas Meter Ground Floor



General Teaching	Library
Science	Resource Areas
I.T.	Common Room
Art	Nursery
Technology	Other
Music	Other
Drama	Staff and Admin Spaces
P.E.	Pupil Changing/Toilets
S.E.N.	Teaching Storage
Private Study	Kitchen/Dining
Hall	Ancillary/Circulation



01	Updated by Cad-Capture	CC	ARB	31/10/2018
00	Updated by Cad-Capture	CC	ARB	15/10/2014

London Borough of Hounslow  
**CAD-CAPTURE**  
 CAD-CAPTURE AssetCapture™ www.assetcapture.net Tel: 01254 504450

Property: Alexandra Primary School  
 Title: Ground Floor Plan Sheet 4

<b>Area Information</b>	Job: S6615
Total Site Area: 14285.1	Scale: 1:100@A1 1:200@A3
Gross External Area: 4344.8	Date: 15/10/2014
Gross Internal Area: 4119.1	Survey: 05/09/2014
Total Room Area: 3898.0	Drawn: CAD-CAPTURE
Net Internal Area: 2663.2	Checked: ARB
Filename: 2014 - Alexandra Primary School.dwg	
Drawing No: 313/2014	



DO NOT SCALE FROM DRAWING. ALL DIMENSIONS MUST BE TAKEN ON SITE.

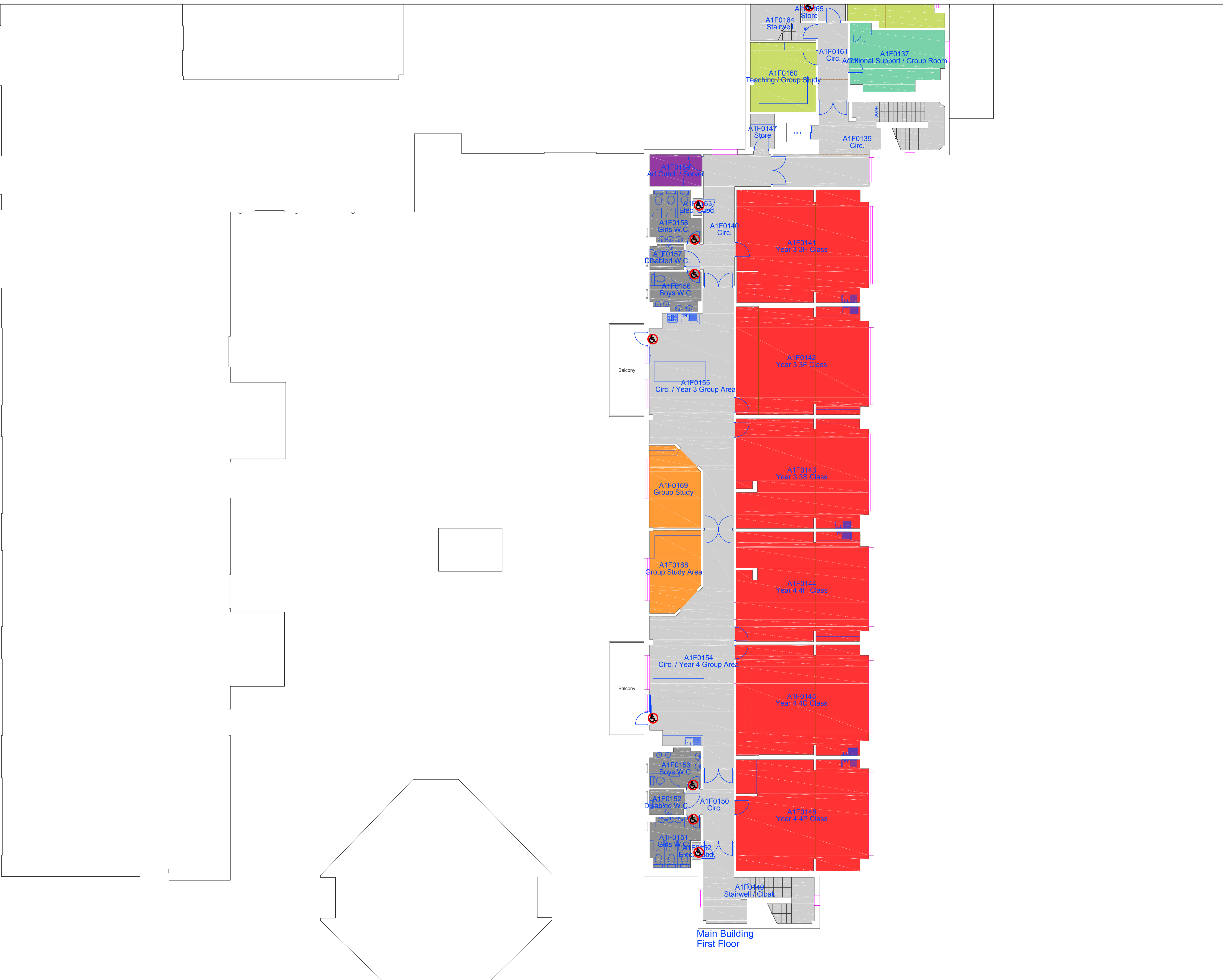
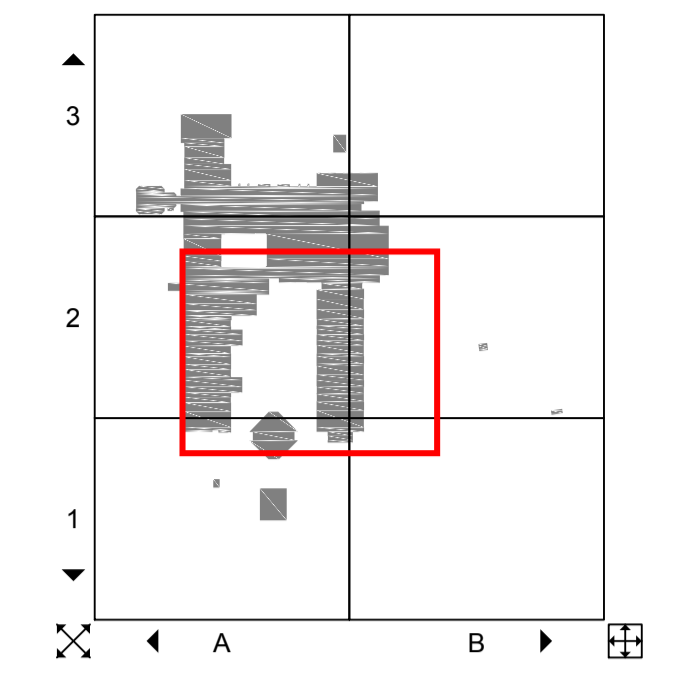

General Teaching	Library
Science	Resource Areas
I.T.	Common Room
Art	Nursery
Technology	Other
Music	Other
Drama	Staff and Admin Spaces
P.E.	Pupil Changing/Toilets
S.E.N.	Teaching Storage
Private Study	Kitchen/Dining
Hall	Ancillary/Circulation



Rev	Description	Drm	Chk	Date
01	Updated by Cad-Capture	CC	ARB	31/10/2018
00	Updated by Cad-Capture	CC	ARB	15/10/2014

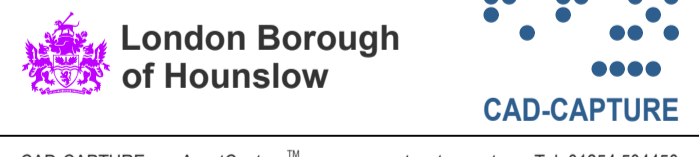

CAD-CAPTURE AssetCapture™ www.assetcapture.net Tel: 01254 504450

Property: Alexandra Primary School  
 Title: First Floor Plan Sheet 1

<b>Area Information</b>	Job: S6615
Total Site Area: 14285.1	Scale: 1:100@A1 1:200@A3
Gross External Area: 4344.8	Date: 15/10/2014
Gross Internal Area: 4119.1	Survey: 05/09/2014
Total Room Area: 3898.0	Drawn: CAD-CAPTURE
Net Internal Area: 2663.2	Checked: ARB
Filename: 2014 - Alexandra Primary School.dwg	
Drawing No: 313/2014	

DO NOT SCALE FROM DRAWING. ALL DIMENSIONS MUST BE TAKEN ON SITE.

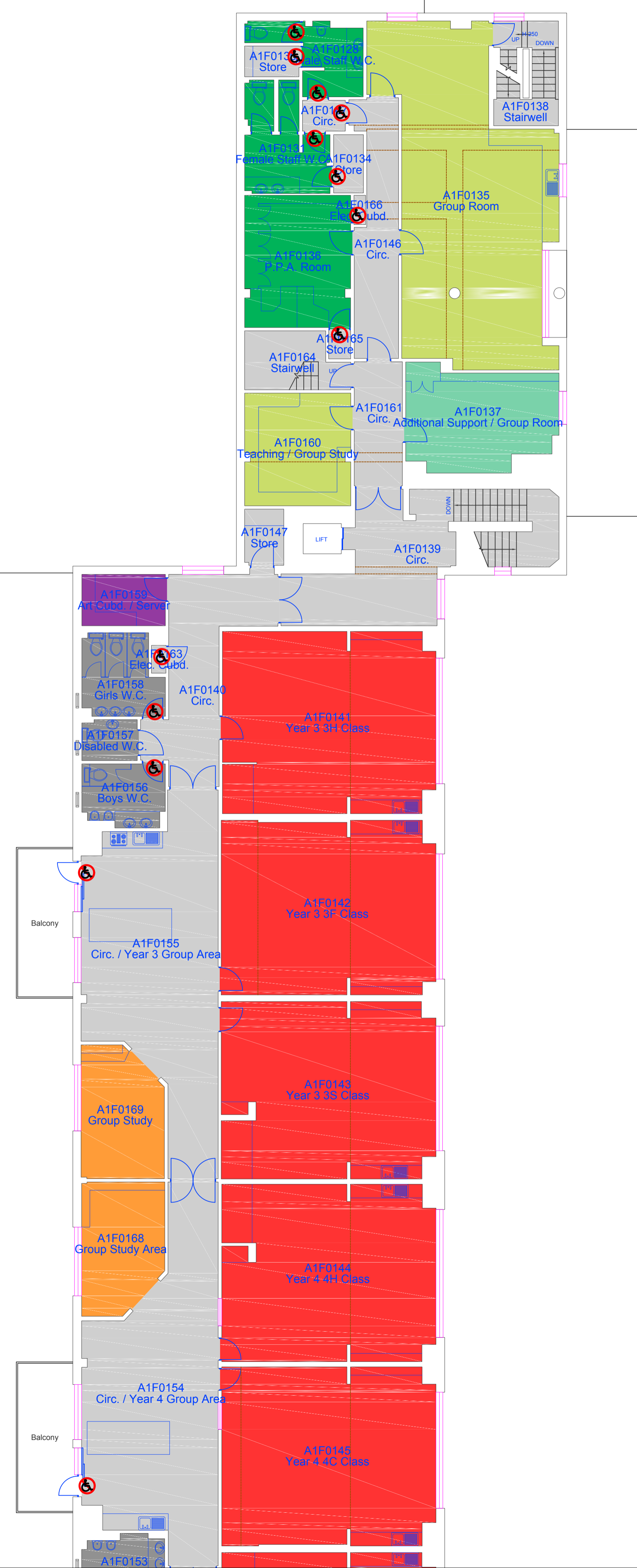
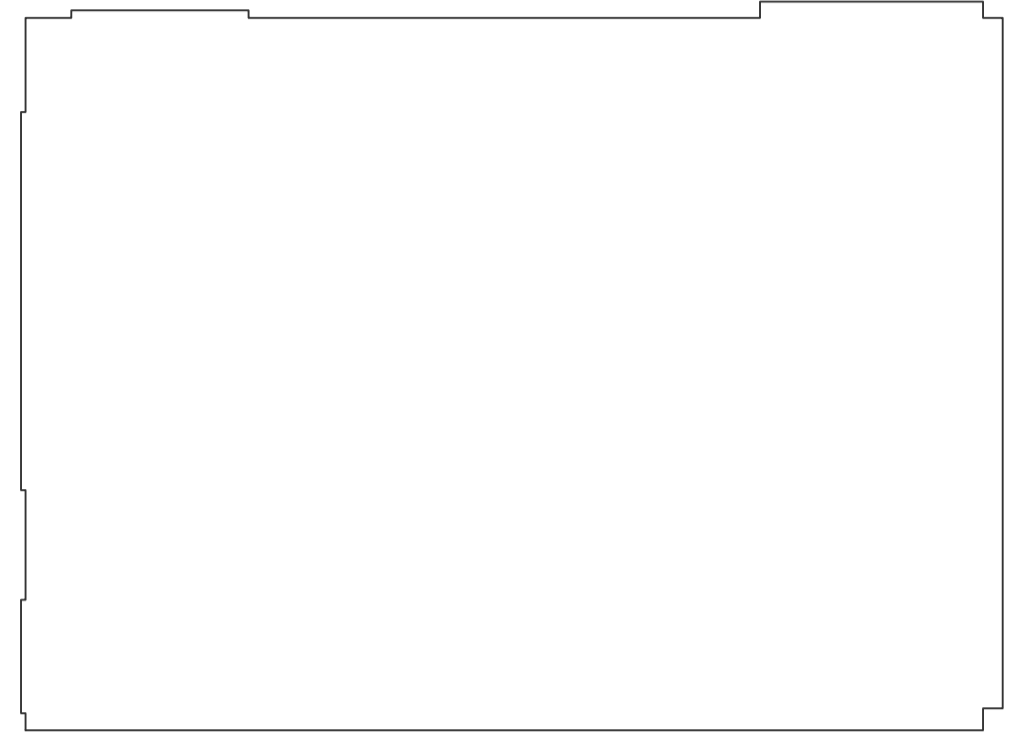
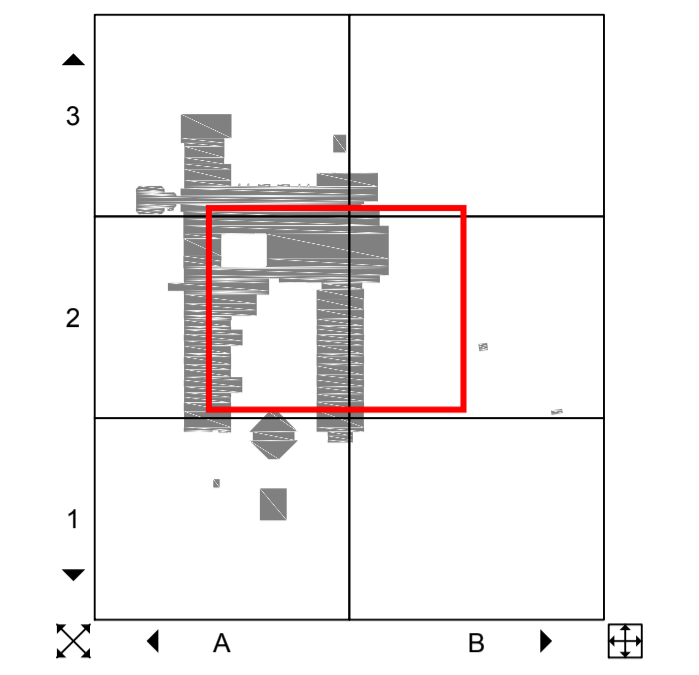

- |  |                  |  |                        |
|--|------------------|--|------------------------|
|  | General Teaching |  | Library                |
|  | Science          |  | Resource Areas         |
|  | I.T.             |  | Common Room            |
|  | Art              |  | Nursery                |
|  | Technology       |  | Other                  |
|  | Music            |  | Other                  |
|  | Drama            |  | Staff and Admin Spaces |
|  | P.E.             |  | Pupil Changing/Toilets |
|  | S.E.N.           |  | Teaching Storage       |
|  | Private Study    |  | Kitchen/Dining         |
|  | Hall             |  | Ancillary/Circulation  |



01	Updated by Cad-Capture	CC	ARB	31/10/2018
00	Updated by Cad-Capture	CC	ARB	15/10/2014
Rev	Description	Drm	Chk	Date

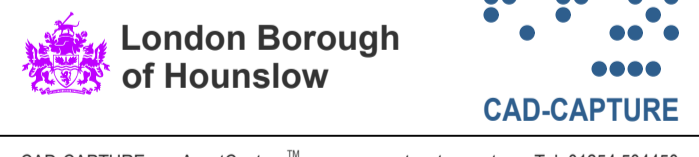

CAD-CAPTURE AssetCapture™ www.assetcapture.net Tel: 01254 504450

Property: Alexandra Primary School  
 Title: First Floor Plan Sheet 2

<b>Area Information</b>	Job: S6615
Total Site Area: 14285.1	Scale: 1:100@A1 1:200@A3
Gross External Area: 4344.8	Date: 15/10/2014
Gross Internal Area: 4119.1	Survey: 05/09/2014
Total Room Area: 3898.0	Drawn: CAD-CAPTURE
Net Internal Area: 2663.2	Checked: ARB
Filename: 2014 - Alexandra Primary School.dwg	
Drawing No: 313/2014	

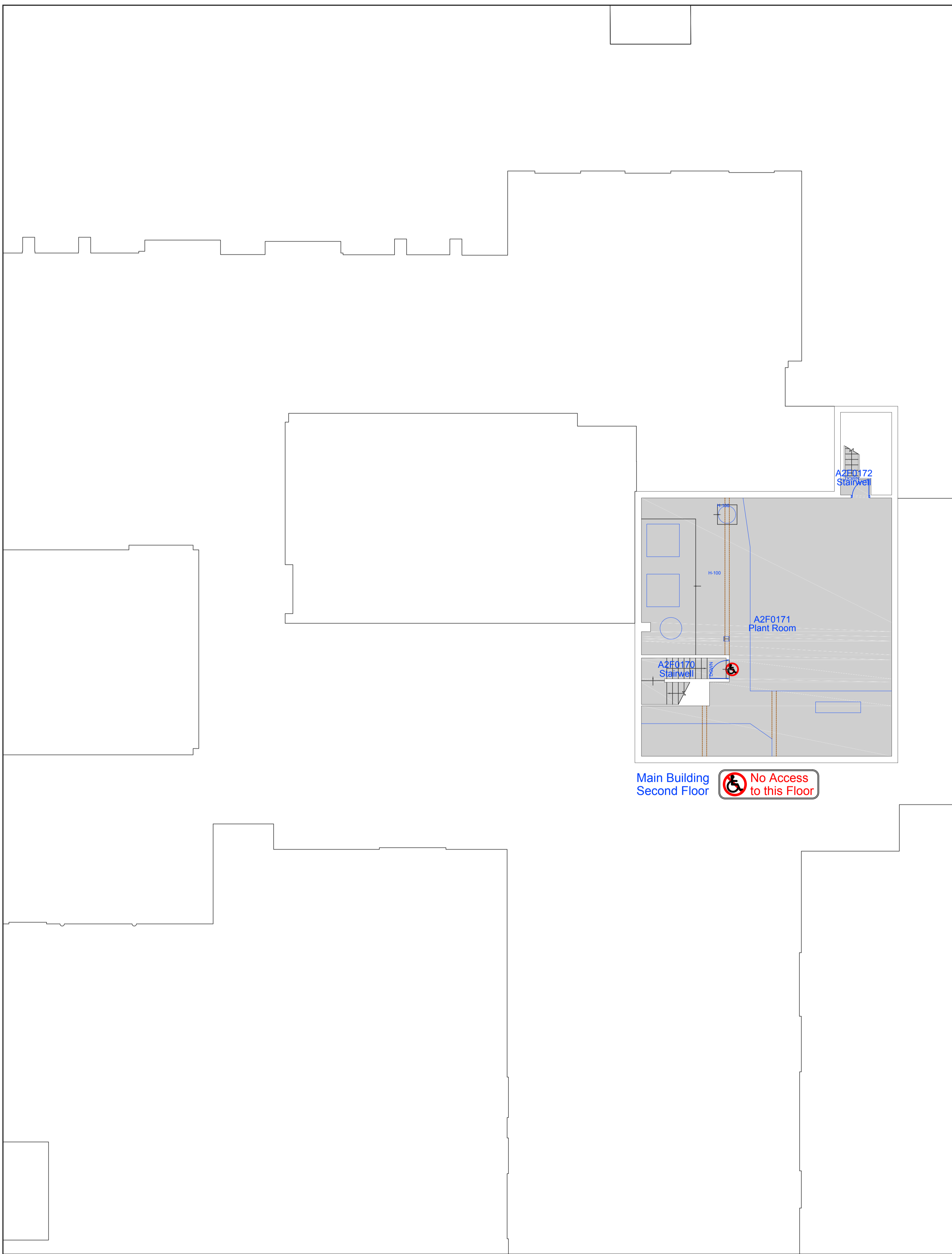
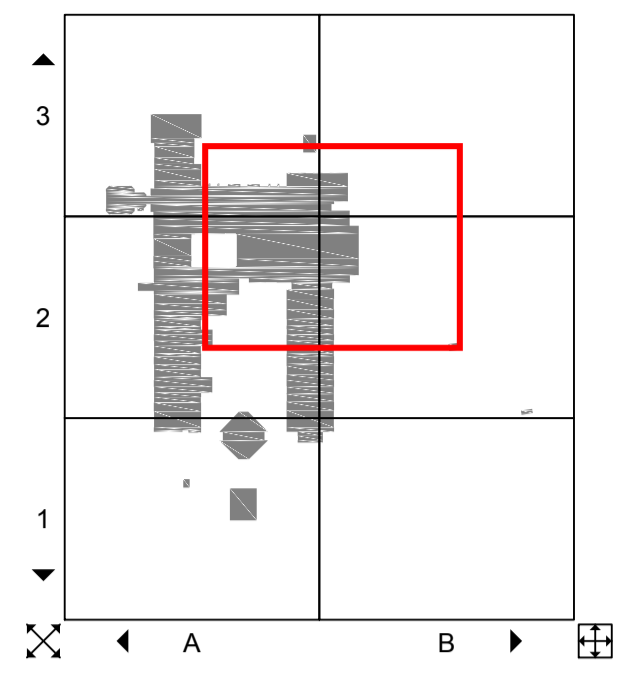

- General Teaching
- Library
- Science
- Resource Areas
- I.T.
- Common Room
- Art
- Nursery
- Technology
- Other
- Music
- Other
- Drama
- Staff and Admin Spaces
- P.E.
- Pupil Changing/Toilets
- S.E.N.
- Teaching Storage
- Private Study
- Kitchen/Dining
- Hall
- Ancillary/Circulation

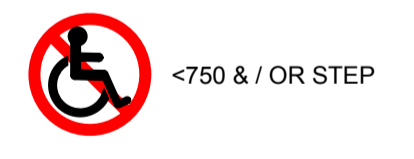

01	Updated by Cad-Capture	CC	ARB	31/10/2018
00	Updated by Cad-Capture	CC	ARB	15/10/2014
Rev	Description	Drm	Chk	Date

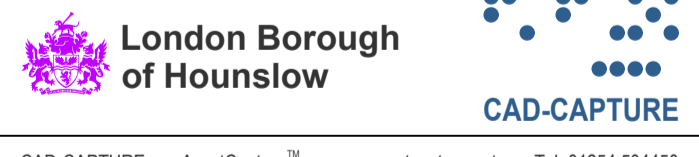

Property: Alexandra Primary School  
 Title: Second Floor Plan Sheet 1

<b>Area Information</b>		Job: S6615	
Total Site Area:	14285.1	Scale:	1:100@A1 1:200@A3
Gross External Area:	4344.8	Date:	15/10/2014
Gross Internal Area:	4119.1	Survey:	05/09/2014
Total Room Area:	3898.0	Drawn:	CAD-CAPTURE
Net Internal Area:	2663.2	Checked:	ARB
Filename:	2014 - Alexandra Primary School.dwg		
Drawing No:	313/2014		